

Piece Part BOM					
Item #	Part #	Description	Material	Qty.	REV
①	30K-250HP-C	1/4" H.P. Case	17-4 PH Stainless Steel Condition H900 per ASTM A 564/564M	1	-
②	30K-375HP-C	3/8" H.P. Case		1	-
③	30K-250HP-P	1/4" H.P. Plug		1	-
④	30K-375HP-P	3/8" H.P. Plug		1	-
⑤	30K-250HP-S	1/4" H.P. Sleeve		1	A
⑥	30K-375HP-S	3/8" H.P. Sleeve		1	A
⑦	59031 ①	Element O-ring	See O-ring Material Chart	1	N/A
⑧	501601	Sleeve O-ring	PTFE	1	N/A
⑨	411 ② - ② ③	Element	See Element Chart	1	-

Assembly Code  
 30K-XXXHP- ② ③ ④  
 XXX: 250 for 1/4" HP  
 375 for 3/8" HP

REVISIONS			
DRAWING REV.	DESCRIPTION	DATE	APPROVED
-	GEWO: 11-149 ECO: 643	10/24/11	JB
A	ECO: 1282	6/16/16	JB
B	PER ECO 1633: UPDATED ELEMENT TABLE TO SHOW MOTT MEDIA GRADES ONLY	4/4/18	KH
C	ECO 2347: 12 µm option added	10/2/19	JB

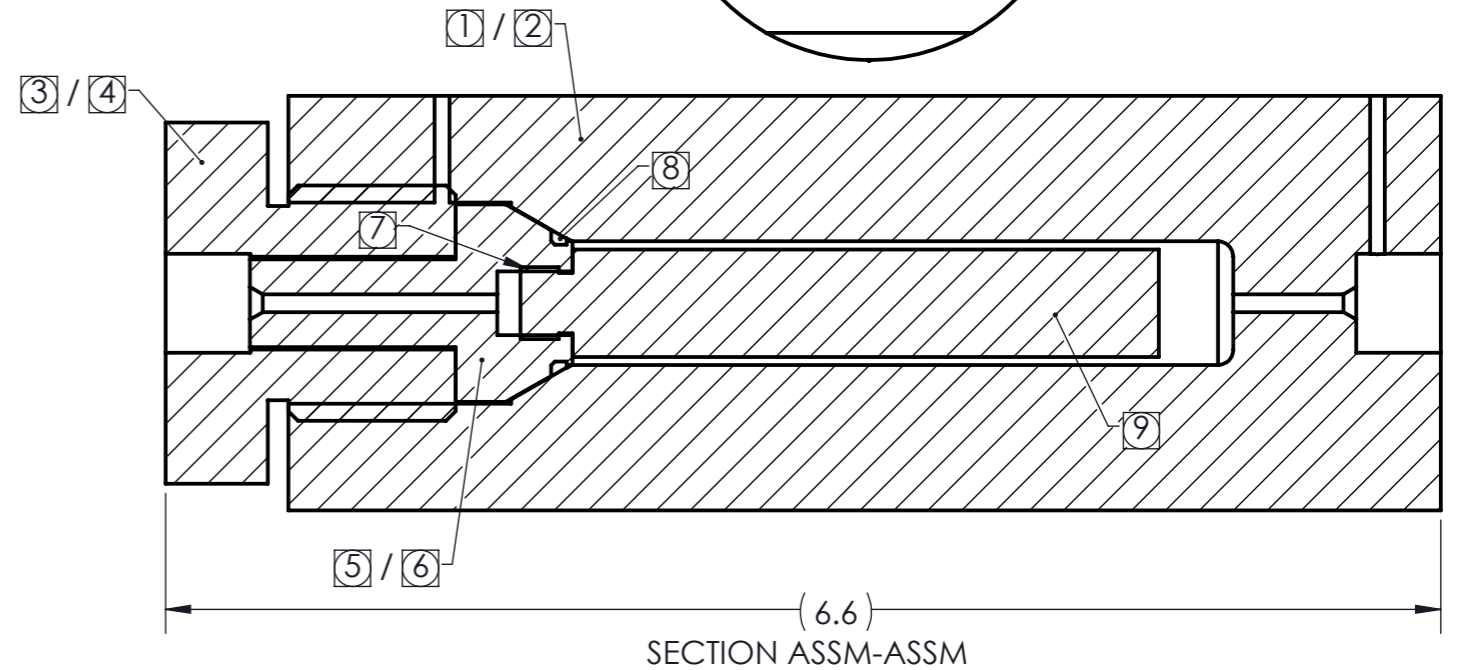
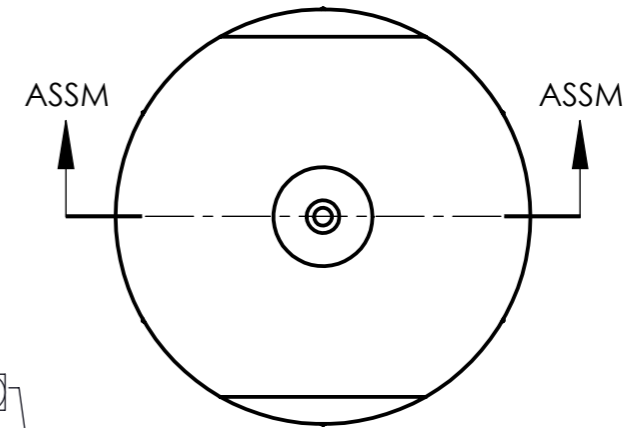

Element Table										
② Micron Code			Collapse & Material Code							
Nom.	Abs.	Code	③ Code	Rating	Material	② Code				
.2	.5	.5 ABS	C	3250 psid	Glass Fiber	F				
.5	1	1 ABS								
2	3	3 ABS								
5	7.5	7 ABS								
2	10	2X								
2	12	02	V	4500 psid	316 Stainless Steel Mesh per AMS QQ-S-763	T				
5	18	05								
10	25	10								
20	40	20								
40	75	40								
75	100	75								
100	200	100								
200	300	200								
Gas Abs.	Liquid Abs.	Code					③ Code	Rating	Material	② Code
0.2	1.4	0.2					F	3000 psid	316 L Porous Sintered Stainless Steel	P
0.3	2.2	0.5								
0.7	3.3	1								
2	9	2								
5	13	5								
13	20	10								
20	35	20								

O-ring Material Code Table		
④ Assembly Code	① Piece Part Code	Material
M	01	PTFE
E	03	EPR
L	06	Buna, 70 durometer
K	07	Buna, 90 durometer
H	16	Kalrez
N	18	Viton

Notes:  
 1. Parts Cleaned per OPMF-500 prior to shipment.  
 2. Stainless Steel Mesh Elements are bubble point tested per ARP-901 with NFC DEN02-12 as accept/reject criteria.

Performance Criteria  
 1. MAWP 30,000 psi @ 70 °F  
 2. Filtration: see Element Table Code ②

UNLESS OTHERWISE SPECIFIED DIMENSIONS ARE IN INCHES  
 TOLERANCES ON:  
 2 PLACE DECIMAL: .XX +/- 0.01  
 3 PLACE DECIMAL: .XXX +/- 0.005  
 ANGULAR: +/- 0.5°  
 PART TO BE FREE OF BURRS  
 REMOVE SHARP EDGES (FILLET 0.005" - 0.020") DO NOT INSPECT SURFACE FINISH 125 Ra UNLESS NOTED OTHERWISE DO NOT INSPECT IF PART REVISION IS NOT SPECIFIED, PART REV. MATCHES DRAWING REV.



TITLE: 30K INLINE  
 PART NUMBER: 30K-XXXHP- ② ③ ④ PART REV: C  
 DWG NO. 30K-XXXHP- ② ③ ④ CAGE CODE 59165 SIZE A3